

### GELIJKVLOERS

BRUTO OPP. 54.0m<sup>2</sup>  
excl. overdekte inkom

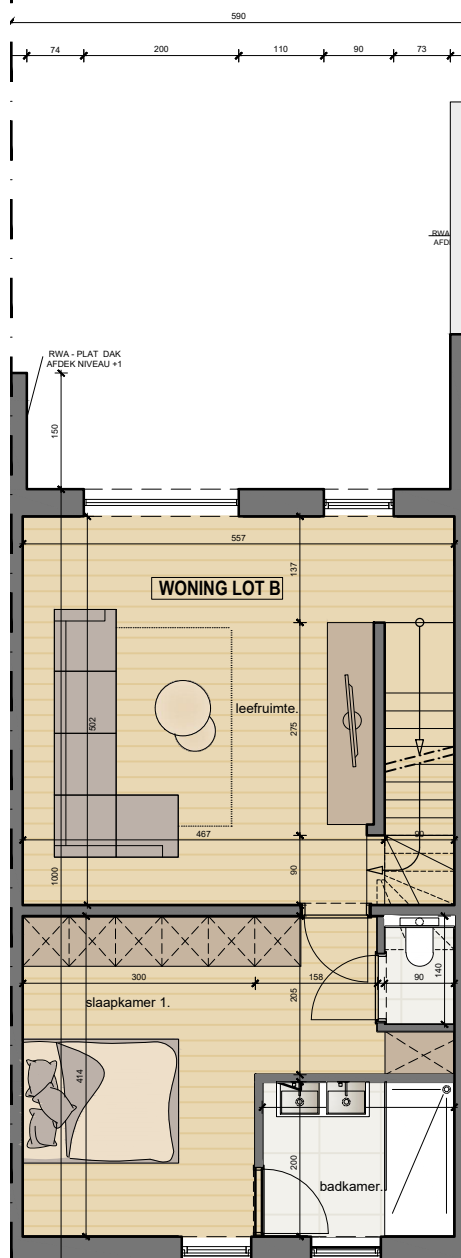

### VERDIEPING 1

BRUTO OPP. 59.0m<sup>2</sup>

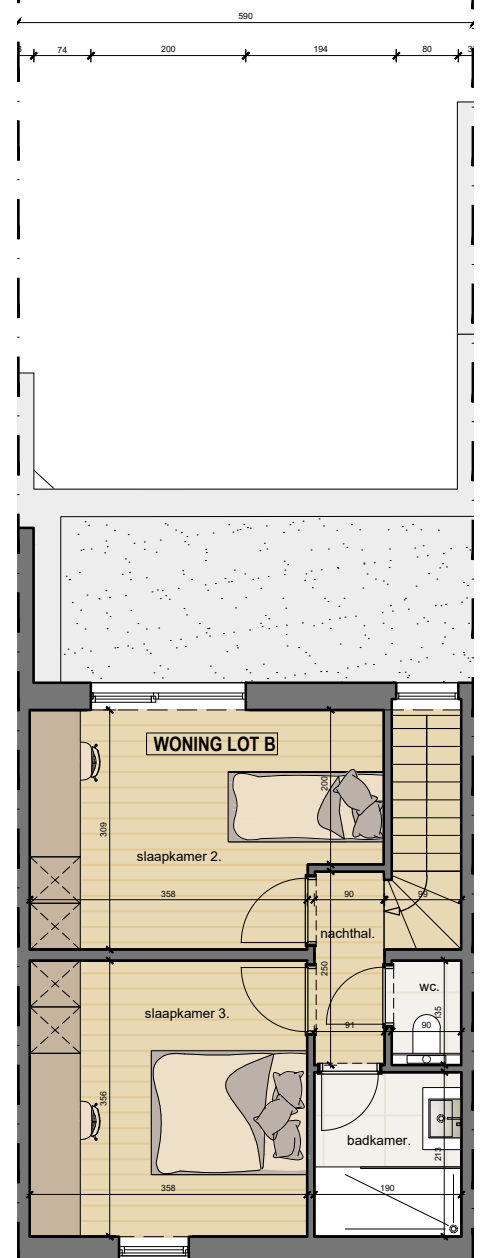

### VERDIEPING 2

BRUTO OPP. 44.2m<sup>2</sup>

## WONING LOT B

BRUTO SCHAKELWONING B - 3 SLAAPKAMERS  
BRUTO OPP.: 157.2m<sup>2</sup>

